



# 12 FLAT BUILD TO RENT RETRO-FIT WI-FI INSTALLATION

Landlord Broadband were contacted to tackle the Wi-Fi in a tall Georgian property in central London. Naturally, these properties come with all kinds of Wi-Fi problems due to their structure and building materials. The age and layout of this particular building meant that installing the data cabling was hugely challenging, especially when Wi-Fi was needed for twelve flats across five floors. Of course, this was nothing that Landlord Broadband couldn't fix!



## Coverage

- 67 dBm Wi-Fi signal to all tenanted areas in the property



## Security

A secure, roaming Wi-Fi throughout the whole building

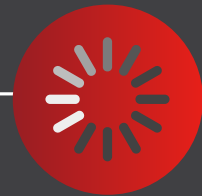

## Capacity

Sufficient capacity to accommodate users working from home, video calling, streaming and online gaming

Address : The Catalyst, Baird Lane, York, YO10 5GA

Phone : 0333 577 0600

Mailbox : [customer.service@landlordbroadband.com](mailto:customer.service@landlordbroadband.com)



**0333 577 0600**

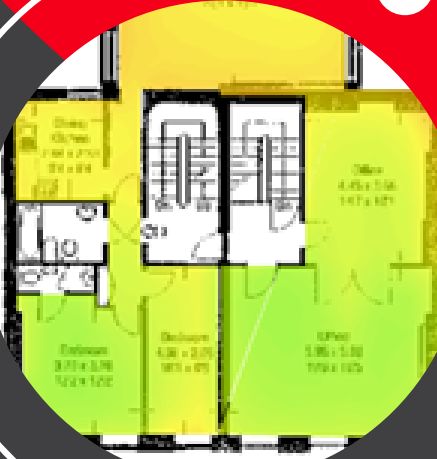

## OUR BESPOKE WI-FI SOLUTION

- A Retro-Fit Wi-Fi Installation, before which we assessed the proposed Access Point locations by testing the performance & coverage to ensure that there are sufficient devices throughout.
- After our experts created and tested a bespoke Wi-Fi design on our state-of-the-art software, we then completed the installation of the network & Wi-Fi equipment.

## THE WI-FI DESIGN & INSTALLATION

- Our installation firstly involved conferring with the client to ensure we really understood their needs. This involved a site survey and a Wi-Fi design being created using the floor plans. Our design work involved testing multiple Wi-Fi access point locations throughout the property, assessing cable routes and creating Wi-Fi heatmaps to ensure that all tenants have access to reliable Wi-Fi, meaning hassle-free property management for the landlord.
- We set up the network cabinet to house the main router and network switch neatly, which is especially useful for larger installations. This was followed by installing, terminating & testing 11 data cables to ensure all infrastructure met our standards.

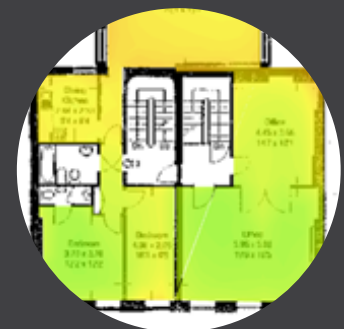
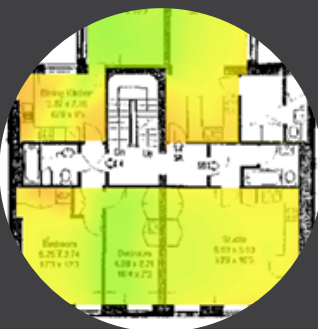

Address : The Catalyst, Baird Lane, York, YO10 5GA

Phone : 0333 577 0600

Mailbox : [customer.service@landlordbroadband.com](mailto:customer.service@landlordbroadband.com)



**0333 577 0600**



## GETTING ONLINE

- After this, we mounted the Wi-Fi access points into their dedicated locations which ensured that all tenants had a robust and reliable service in all rooms and no dead-zones throughout the property, which means less hassle for both the tenant and the landlord!
- Finally, we configured the Wi-Fi network and carried out final testing from all areas, to ensure there were no hiccups, and that tenants could get online as soon as possible.
- Then, tenants were able to access the network simply through the log on details that we had provided. Truly Wi-Fi Friendly accommodation!

## THE RESULT

Our specialised retro-fit Wi-Fi not only decreased hassle, through our 24/7/365 Tenant Support Desk and nationwide network of engineers, both on hand to help in the (unlikely) event of problems. We also ensured a seamless roaming Wi-Fi service and offering a strong and reliable Wi-Fi connection to all 12 flats allow users to simultaneously video call, game, work from home & stream.



Address : The Catalyst, Baird Lane, York, YO10 5GA

Phone : 0333 577 0600

Mailbox : [customer.service@landlordbroadband.com](mailto:customer.service@landlordbroadband.com)

\*Access point photo is demonstrative and not part of this development.



**0333 577 0600**